

SPECIFICATIONS

FLOAT AND THERMOSTATIC

BODY AND COVER: CAST IRON 30,000 PSI TENSILE

VALVE PIN AND SEAT: STAINLESS STEEL (HARDENED)

FLOAT: STAINLESS STEEL

LEVER ASSEMBLY: STAINLESS STEEL

THERMOSTATIC AIR VENT: STAINLESS STEEL CAGE AND THERMAL ELEMENT

COVER BOLTS: GRADE 5

DIMENSIONS in (mm)

PART #	CONN. SIZE (IN.)	A	B	C	D	E	F	G	H	J	WEIGHT LBS (KG)
99136-7	1-1/4	4-1/4 (108)	8-5/16 (211)	8-9/16 (217)	3 (76)	3-3/8 (86)	2 (51)		45/64 (17.8)	1-3/8 (35)	18 (8)
99136-8	2	7-3/16 (183)	10-1/8 (257)	10-1/2 (267)	4-15/16 (379)	2-11/16 (68)	3-1/4 (83)	1/2 (12.7)	1/8 (3.2)		33 (15)
99136-9 (SEE NOTE)	2	10 (254)	15 (381)	15-1/2 (394)	6-5/8 (168)	4-3/4 (121)	3-1/2 (89)				108 (49)

99136-7

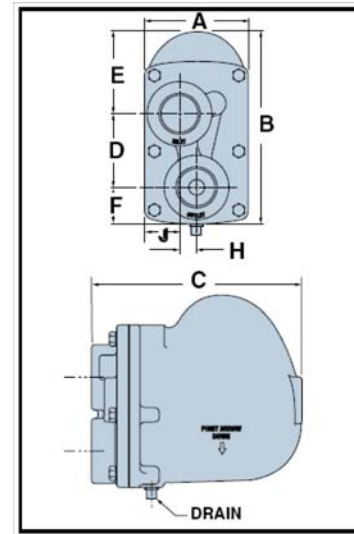

99136-8

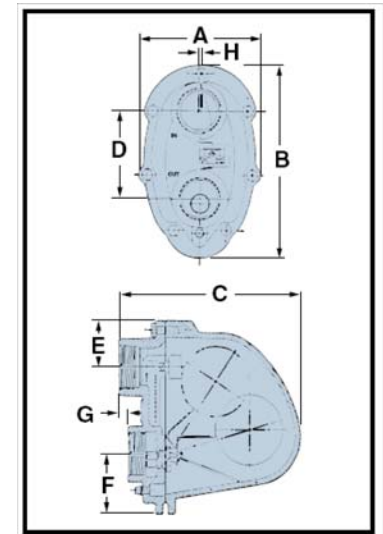

Capacities (Gross Ratings)

PART #	CONNECTION SIZE in.	ORIFICE SIZE in. (mm)	Pressure Differential in Pounds Per Square Inch (bar)								
			1/4 (0.017)	1/2 (0.035)	1 (0.07)	2 (0.14)	5 (0.35)	10 (0.69)	15 (1.0)	20 (1.4)	25 (1.69)
			Capacities in Pounds of Condensate Per Hour (kg/hr)								
99136-7	1-1/4	.312 (8)	600 (272)	800 (363)	1040 (470)	1410 (640)	2200 (1000)	3100 (1405)	3800 (1725)	4100 (1860)	4500 (2040)
99136-8	2	.390 (10)	1000 (453)	1350 (612)	1700 (771)	2150 (975)	2950 (1338)	3600 (1632)	4300 (1950)	4850 (2199)	5400 (2449)
99136-9 (SEE NOTE)	2	.585 (15)	2550 (1156)	3150 (1428)	4300 (1930)	5450 (2472)	7600 (3447)	10400 (4717)	11400 (5171)	12500 (5670)	13500 (5123)

99136-9 (SEE NOTE)

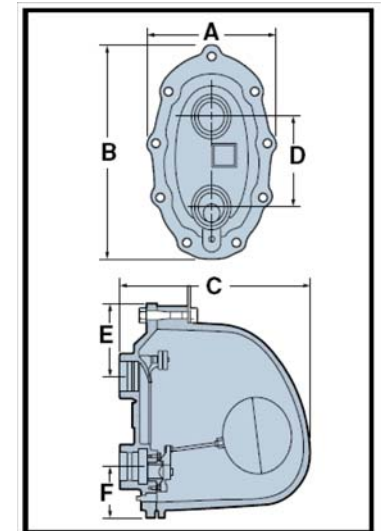

Selection Guide:

- Maximum steam pressure TO THE CONTROL VALVE = 75 PSIG.
- Select the Trap based on the following Pressure Differentials and Factor of Safety:

Steam Pressure TO HEAT EXCHANGER (OUTLET of Control Valve)	Pressure Differential to Use for Steam Trap Selection	Factor of Safety to Use for Steam Trap Selection
up to 15 psi	1/2 psi (1-1/4" SIZE) 1 psi (2" SIZE)	1.5
16 - 30 psi	5 psi	1.5
31-50 psi	15 psi	1.5
51-70 psi	25 psi	1.5

NOTE:

The inlet connection of 99136-9 is vertically higher (~10.25") than the condensate outlet of the SWDW24 (~9"). The SWDW24 must be installed on a concrete pad to accommodate this trap.

- See document A701.2 for quick selection charts with appropriate pressure differentials and factor of safety already applied.

IMPORTANT:

- Discharge piping from the steam trap must drain by gravity/downhill to atmosphere or vented receiver.
- Do NOT drain to condensate return system or any system that will cause lift/backpressure.

AERCO INTERNATIONAL, INC.
NORTHVALE, NJ 07647

MAIN CONDENSATE TRAP 75 PSI
FLOAT AND THERMOSTATIC

DWN.BY CZ DATE 093010
SCALE _____ SIZE _____
CHKD. _____ APPD. _____
REV. DATE _____

AP-A-884

REV. A