

SPECIFICATIONS

FLOAT AND THERMOSTATIC

BODY AND COVER: CAST IRON 30,000 PSI TENSILE

VALVE PIN AND SEAT: STAINLESS STEEL (HARDENED)

FLOAT: STAINLESS STEEL

LEVER ASSEMBLY: STAINLESS STEEL

THERMOSTATIC AIR VENT: STAINLESS STEEL CAGE AND THERMAL ELEMENT

COVER BOLTS: GRADE 5

DIMENSIONS in (mm)

PART #	CONN. SIZE (IN.)	A	B	C	D	E	F	G	H	J	WEIGHT LBS (KG)
99136-1	1-1/2	4-1/4 (108)	8-5/16 (211)	8-9/16 (217)	3 (76)	3-3/8 (86)	2 (51)		45/64 (17.8)	1-3/8 (35)	18 (8)
99136-2	2	7-3/16 (183)	10-1/8 (257)	10-1/2 (267)	4-15/16 (379)	2-11/16 (68)	3-1/4 (83)	1/2 (12.7)	1/8 (3.2)		33 (15)
99136-3 (SEE NOTE)	2	10 (254)	15 (381)	15-1/2 (394)	6-5/8 (168)	4-3/4 (121)	3-1/2 (89)				108 (49)

Capacities (Gross Ratings)

PART #	CONNECTION SIZE in.	ORIFICE SIZE in. (mm)	Pressure Differential in Pounds Per Square Inch (bar)		
			1/4 (0.017)	1/2 (0.035)	1 (0.07)
			Capacities in Pounds of Condensate Per Hour (kg/hr)		
99136-1	1-1/2	.5 (12.7)	1100 (500)	1700 (770)	
99136-2	2	.687 (17.4)	2300 (1043)	2800 (1270)	3600 (1630)
99136-3 (SEE NOTE)	2	.970 (24.6)	6500 (2950)	8000 (3628)	9500 (4310)

Selection Guide:

- Maximum steam pressure TO THE CONTROL VALVE = 15 PSIG.
- Select the Trap based on:
 - 1/2 psi Pressure Differential (1-1/2" SIZE)
 - 1 psi Pressure Differential (2" SIZE)
 - 1.5 Factor of Safety (All Sizes)
- See document A701.2 for quick selection charts with appropriate pressure differentials and factor of safety already applied.

NOTE:

The inlet connection of 99136-3 is vertically higher (~10.25") than the condensate outlet of the SWDW24 (~9"). The SWDW24 must be installed on a concrete pad to accommodate this trap.

IMPORTANT:

- Discharge piping from the steam trap must drain by gravity/downhill to atmosphere or vented receiver.
- Do NOT drain to condensate return system or any system that will cause lift/backpressure.

99136-1

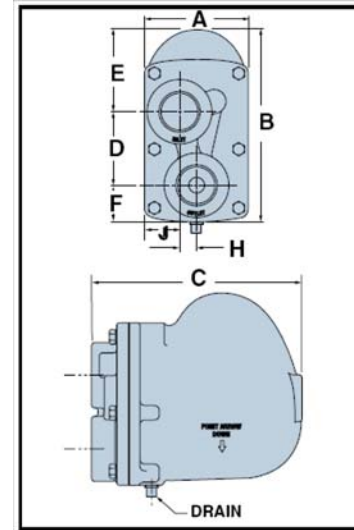

99136-2

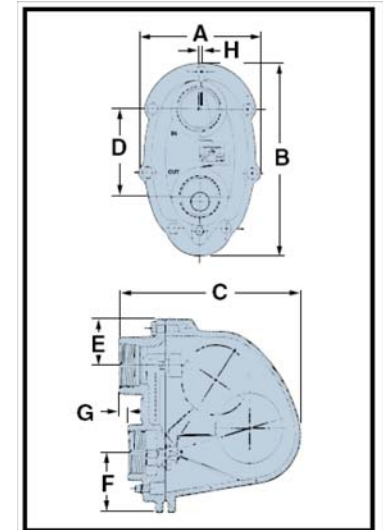

99136-3 (SEE NOTE)

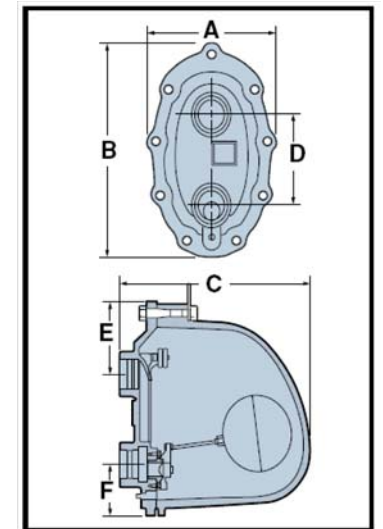

AERCO INTERNATIONAL, INC.
NORTHVALE, NJ 07647

MAIN CONDENSATE TRAP 15 PSI
FLOAT AND THERMOSTATIC

DWN.BY CZ DATE 093010
SCALE _____ SIZE _____
CHKD. _____ APPD. _____
REV. DATE _____

AP-A-882

REV. **A**