

## Electrical Power Design Guide

# Modulex<sup>®</sup> EXT Series Modulating and Condensing Boilers

- MLX EXT 450 2S
- MLX EXT 600 2S
- MLX EXT 800 2S
- MLX EXT 1100 2S
- MLX EXT 1500 2S
- MLX EXT 2300 2S
- MLX EXT 2600 2S
- MLX EXT 3000 2S

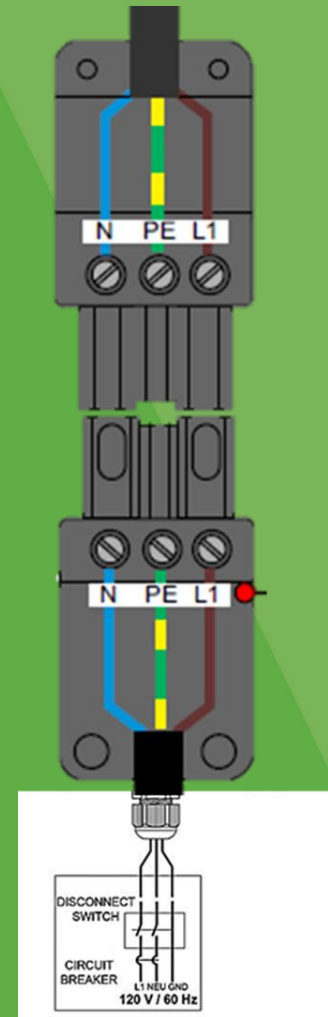

### Disclaimer

The information contained in this manual is subject to change without notice from AERCO International, Inc. AERCO makes no warranty of any kind with respect to this material, including, but not limited to, implied warranties of merchantability and fitness for a particular application. AERCO International is not liable for errors appearing in this manual, not for incidental or consequential damages occurring in connection with the furnishing, performance, or use of these materials.

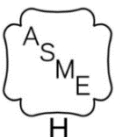

## 1. PROVISIONS FOR SERVICE

Designers must provide emergency shutoffs and other devices to satisfy electrical codes. It is also recommended to provide an electrical shutoff disconnect switch of suitable load carrying characteristics on or near **each** Modulex boiler. No electrical boxes or field components should be mounted to the surface of the boiler or where they would interfere with the removal of the side or top panels for maintenance. The disconnect switch should be mounted near the unit as illustrated in Figure 1. Wiring conduit, EMT, or other wiring paths should not be secured to the unit, but supported externally. Electricians should be instructed as to where the wiring conduit should be located, such as away from the relief valve discharge, drains, etc. All electrical conduit and hardware should be installed so that it does not interfere with the removal of any cover, inhibit service or maintenance, or prevent access between the unit and walls or another unit.

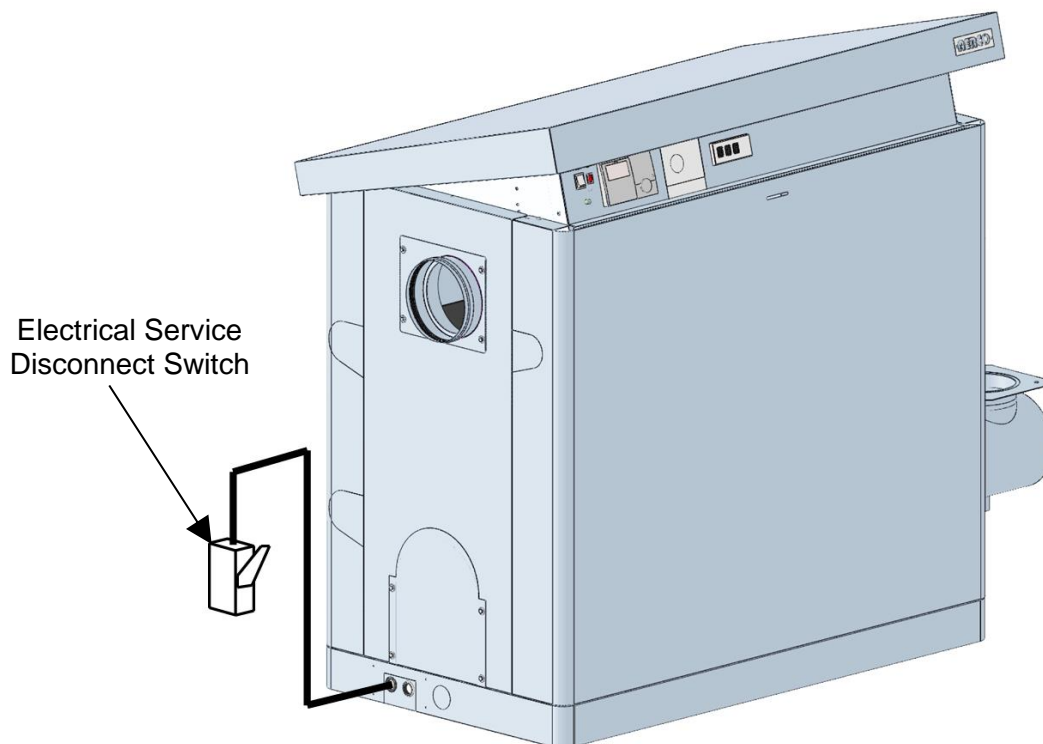

**Figure 1: Service Switch Typical Location**

## 2. SINGLE UNIT WIRING

When installing a single Modulex boiler a dedicated protected circuit should be provided from the power source to the boiler. No other electrical devices should be permanently wired on the same circuit. An emergency switch (electrical shutoff) must be in series with the power to the unit.

Use the following disconnect switch and circuit breaker size:

- Models MLX EXT 450 2S - 1100 2S: 15 AMP
- Models MLX EXT 1500 2S - 3000 2S: 30 AMP

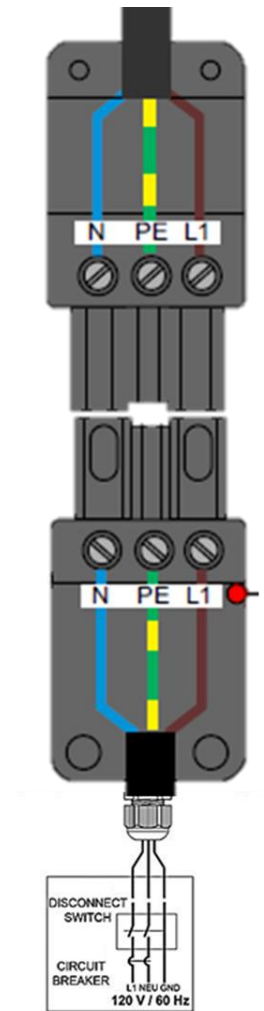

**Figure 2: Modulex EXT Power Wiring Schematics**

## 3. MULTIPLE UNIT WIRING

Whenever multiple units are installed within the same mechanical spaces, electrical code requirements call for a single electrical shutoff for emergency use. It is the responsibility of the electrical designer to comply with local codes and regulations affecting an individual installation.